



Wireless External Alarm
Model: SA-001S

User's Instructions

TABLE OF CONTENT

INTRODUCTION.....	2
INSTALLATION.....	2-4
PROGRAMMING –	
LEARN REMOTE OR SENSORS OR CONTROL PANEL.....	4-6
ERASE REMOTE OR SENSOR OR CONTROL PANEL FROM THE WIRELESS EXTERNAL ALARM.....	7
ALARM SOUND DURATION.....	7
ARMING SEQUENCE.....	8-9
OPERATING THE SKYLINK SECURITY CONTROL PANEL.....	10-11
CONNECT THE WIRELESS EXTERNAL ALARM WITH YOUR EXISTING ALARM SYSTEM.....	11
ALERT NOTIFICATION JUMPER.....	12
BATTERY.....	13
TAMPER PROTECTION.....	13
SOLAR POWER INSTALLATION.....	13-14
MAINTENANCE.....	14
TROUBLE SHOOTING.....	15
FCC	16
IC.....	17
CE.....	17
WARRANTY	17
CUSTOMER SERVICE	18

INTRODUCTION

Congratulations on purchasing the Skylink Wireless External Alarm SA-001 Series. The SA-001 Series provide you with a piercing siren and powerful features yet ease to use. You will find the installation to be simple and be able to get the unit up and running easily.

The following items are included in this package:

- One Wireless External Alarm
- AC adapter *
- Rechargeable Battery Pack
- User's Instructions

* - Option



INSTALLATION

- Remove the cover of the Wireless External Alarm as shown.



Undo the 2 screws in both sides.

- Set Compatibility Jumper:

Refer to the following table to setup the Wireless External Alarm to work with different Skylink's Security System or Sensors. To select, you will see a jumper connector marked "J2" as shown below. Use a paper clip to remove the jumper connector and re-locate to the proper posts.

	
Models	Jumper (J2) Setting
SC-001, AM-001, ML-001, 4B-101, GS-101, KP-434, PS-101, VS-101, WA-101, WD-101, 4B-434	Set the connector to top 2 posts (1-2)
MA-103, 4B-103, GS-103, KP-103, PS-103, VS-103, WA-103, WD-103	Set the connector to bottom 2 posts (2-3)

- Insert 3 AA-size batteries (not included) to the battery holder or rechargeable battery pack (included) to the unit. Insert the rechargeable battery pack to the black connector marked "NiMH" as shown. The Learn/Set LED will turn on for 1 second and then off. The PWR LED will keep flashing.

- Plug in the AC adapter to an AC outlet and the other end into the DC jack on the Wireless External Alarm. The PWR LED indication will stay on steadily.



Insert the rechargeable battery pack to the black connector marked "NiMH"



Plug in AC adapter

CAUTION:

The adaptor as a disconnect devices: – the socket-outlet shall be installed near the equipment and shall be easily accessible.

PROGRAMMING – LEARN REMOTE OR SENSORS OR CONTROL PANEL

In order for the remote or sensor or control panel to communicate with the External Wireless Alarm properly, this need be programmed into the Wireless External Alarm previously. Follow the brief instructions below to program it to the Wireless External Alarm.

Before proceeding, ensure you have both the Wireless External Alarm and the remote or sensor or control panel next to you.

3A – Learn remote to the Wireless External Alarm:

- Press and hold the Learn button on the Wireless External Alarm for 2 seconds and then release. The Learn/Set LED will flash.
- Activate the remote by pressing any one of the buttons.
- You will hear 2 beeps and the LEDs will flash twice indicating the remote is now programmed to the Wireless External Alarm.

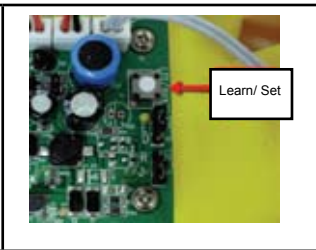
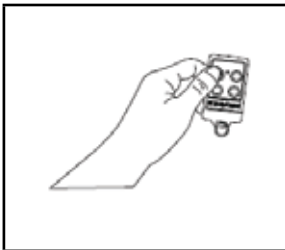

3B – Learn motion sensor to the Wireless External Alarm:

- Press and hold the Learn button on the Wireless External Alarm for 2 seconds and then release. The Learn/Set LED will flash.
- Activate the motion sensor by pressing the "Test/Set" button on the motion sensor. This "Test/Set" button is located inside the battery compartment.
- You will hear 2 beeps and the LEDs will flash twice indicating the sensor is now programmed to the Wireless External Alarm.

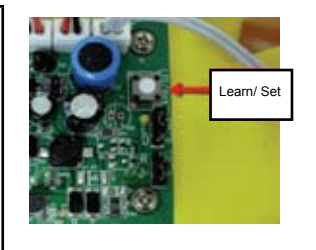
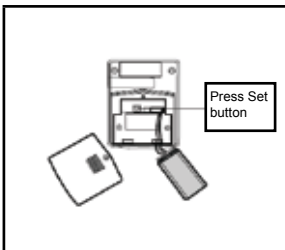

3C – Learn door/window sensor to the Wireless External Alarm:

- Press and hold the Learn button on the Wireless External Alarm for 2 seconds and then release. The Learn/Set LED will flash.
- Activate the Door/Window Sensor, by separating the magnets to send the signal.
- You will hear 2 beeps and the LEDs will flash twice indicating the sensor is now programmed to the Wireless External Alarm.

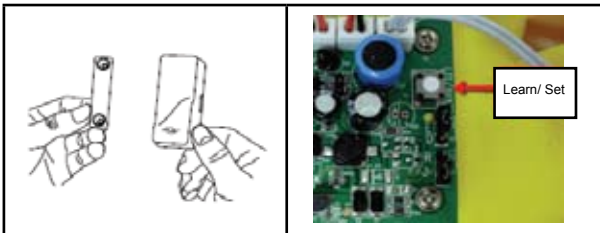

3D – Learn control panel MA-103 to the Wireless External Alarm:

- Press and hold the Learn button on the Wireless External Alarm for 2 seconds and then release. The Learn/Set LED will flash.
- Activate the control panel MA-103 by pressing and hold the Mute button on the side of the control panel for 3 seconds.
- You will hear 2 beeps and the LEDs will flash twice indicating the control panel MA-103 is now programmed to the Wireless External Alarm.

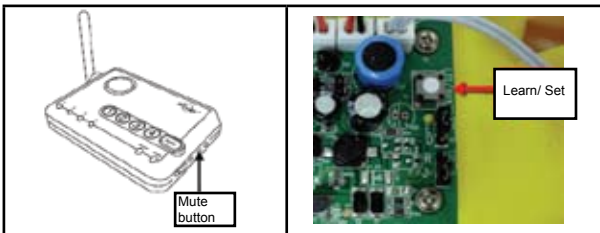

PROGRAMMING – ERASE REMOTE OR SENSOR OR CONTROL PANEL FROM THE WIRELESS EXTERNAL ALARM

To erase unwanted remote(s) or sensor(s) or control panel(s) from the Wireless External Alarm will erase all learned devices from the Wireless External Alarm.

- Press and hold the Learn/Set button on the Wireless External Alarm for 8 seconds.
- While holding the Learn/Set button on the Wireless External Alarm until the Learn/Set LEDs turn on. You may release the Learn/Set button when the Learn/Set LED stay on.
- Press and hold the Learn/Set button again on the Wireless External Alarm for 2 seconds until it emits 2 beeps and all the LEDs flash twice. Now you may release the 'Learn' button.
- All the learned devices have been erased.

PROGRAMMING – ALARM SOUND DURATION

User can customize the alarm period from 30 seconds up to 10 minutes. The factory default of the alarm period is 3 minutes.

- Press and hold the Learn/Set button on the Wireless External Alarm for 5 seconds, you may release the Learn/Set button while all the LEDs turn on.
- While the PWR and Learn/Set LED stay on, press the Learn/Set button once on the Wireless External Alarm, the LEDs flash once indicating the alarm period is set to 30 seconds.
- If you would set the other alarm period, continue to press the Learn/Set button. Refer to the table below for the alarm period. The LEDs will flash corresponding to the number you pressed the Learn/Set button.

- 1- 30 seconds
- 2- 60 seconds
- 3- 3 minutes
- 4- 5 minutes
- 5- 10 minutes

- Press and hold the Learn/Set button to confirm your setting. You will hear 2 beeps and the LEDs will flash twice indicating the alarm period is now programmed to the Wireless External Alarm.

PROGRAMMING – ARMING SEQUENCE

The Wireless External Alarm can be programmed to react 2 arming sequences when it receives the signal from the sensor. In order to arm the Wireless External Alarm, the remote (optional) must be programmed to the Wireless External Alarm. You may arm the Wireless External Alarm in 2 different sequences:

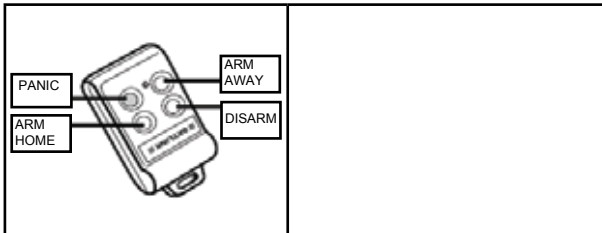

6A – Arm Home Sequence:

This setting is used when you wish to secure the area but will be at home and moving around within the armed area. In Arm Home setting, any motion sensor will not respond to any movement. Alarm will sound instantly if any of the sensors (e.g. door/window sensor) is activated (except motion sensor).

- Pressing the ARM HOME button on the remote will arm the Wireless External Alarm in Home mode.
- You will hear 2 beeps and the LEDs will flash twice indicating the Wireless External Alarm in Home mode.

6B – Arm Away Sequence:

This setting is used when you are the last one to leave the premises. By arming the Wireless External Alarm in Away mode, you will have 30 seconds to leave the premises after arming. After 30 seconds, all sensors in the premises are armed. Activating these sensors in Arm Away mode will result in 30 seconds delay. The alarm will sound if not disarm during the 30 seconds period.

- Pressing the ARM AWAY button on the remote will arm the Wireless External Alarm in Away mode.

- You will hear 1 beep and the LEDs will flash once indicating the Wireless External Alarm is being counted to Away mode.
- After 30 seconds, you will hear 2 beeps and the LEDs will flash twice indicating the Wireless External Alarm in Away mode.

6C – Disarm

- Pressing the DISARM button on the remote will disarm the Wireless External Alarm instantly.
- You will hear 2 beeps and the LEDs will flash twice indicating the Wireless External Alarm is disarmed.

6D - Panic

- Pressing the Panic button on the remote will cause siren instantly.

Note:

- During the Arm Away mode, you will have 30 seconds to leave the premises. This is called the exit delay. When the exit delay expires, the Wireless External Alarm is armed.
- If a sensor is triggered while the Wireless External Alarm is armed, such as entering the premises, an entry delay will be triggered. User is allowed to disarm the Wireless External Alarm during the 30 seconds entry delay. You will hear beeping every 5 seconds during the entry delay interval. If the Wireless External Alarm is not disarmed within 30 seconds, alarm will sound immediately.

OPERATING THE SKYLINK SECURITY CONTROL PANEL

The Wireless External Alarm is designed to work with the Skylink security control panel such as AM-001, ML-001 and SC-001. Put the control panel that you plan to program into programming mode. Refer to the User's Instructions of that control panel.

7A – Learn control panel AM-001 or ML-001 to the Wireless External Alarm:

- Press and hold the Learn button on the Wireless External Alarm for 2 seconds and then release. The Learn/Set LED will flash.
- Activate the control panel AM-001 or ML-001 by pressing [ARM] and then enter your current Master PIN (MPIN) [factory default 1 2 3 4].
- You will hear 2 beeps and the LEDs will flash twice indicating the control panel is now programmed to the Wireless External Alarm.

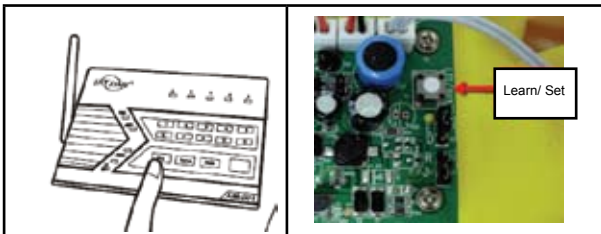

7B – Learn control panel SC-001 to the Wireless External Alarm:

- Press and hold the Learn button on the Wireless External Alarm for 2 seconds and then release. The Learn/Set LED will flash.
- Activate the control panel SC-001 by entering your current Master PIN (MPIN) [factory default 0 0 0], then enter [B], [B].
- You will hear 2 beeps and the LEDs will flash twice indicating the control panel is now programmed to the Wireless External Alarm.



CONNECT THE WIRELESS EXTERNAL ALARM WITH YOUR EXISTING ALARM SYSTEM

You may connect your existing alarm system with the Wireless External Alarm so that the Wireless External Alarm will be triggered by your alarm system. There are 2 ways you can connect your Wireless External Alarm with your existing alarm system. The input terminals (INPUT1 or INPUT2) can be a Normally Open (NO) momentary dry contact or the DC voltage of 12V.

- 8A – Connect your existing alarm system to the INPUT1, this provides the delay trigger until the Wireless External Alarm is armed.
- 8B – Connect your existing alarm system to the INPUT2, this provides the instant alarm.



A LERT NOTIFICATION JUMPER

You can enable or disable the Alert Notification. When it is set to enable, the Wireless External Alarm will beep when arm or disarm or during the entry/exit countdown period. When it is set to disable, the Wireless External Alarm will not beep when arm or disarm or during the entry/exit countdown period. However, the LED will remain flashing as it is. The Wireless External Alarm will still siren when it is triggered.

Unplug all the power (batteries and AC adapter) when setup the Alert Notification. Factory default is set to "Enable". To select, you will see a jumper connector marked "J1" as shown below. Use a paper clip to remove the jumper connector and re-locate to the proper posts. Apply the power to the Wireless External Alarm again after setup the Alert Notification



Alert Notification Jumper (J1)

Mode	Jumper (J1) Setting
Enable	Set the connector to top 2 posts (1-2)
Disable	Set the connector to bottom 2 posts (2-3)

BATTERY

When the battery power is being reduced, the Wireless External Alarm will emit 3 beeps when the remote arm or disarm the unit. It is time to replace the batteries or recharge the battery pack (rechargeable battery only) as soon as the low battery signal appears. Ensure all the batteries are replaced altogether at the same time. The Wireless External Alarm is powered by 3 AA-size Alkaline batteries as the backup purpose. Follow the instructions below to replace the batteries;

1. Remove the cover of the Wireless External Alarm as shown.
2. Remove the old battery. Insert 3 new AA-size Alkaline batteries to the battery compartment. Beware of the battery polarity.
3. Install the cover.

CAUTION:

RISK OF EXPLOSION IF BATTERY IS REPLACED BY AN INCORRECT TYPE. DISPOSE OF USED BATTERIES ACCORDING TO THE INSTRUCTIONS.

TAMPER PROTECTION

The Wireless External Alarm is built-in with the Tamper Protection for system security. When the cover is removed or move the unit to other location after mounted on the wall, the Wireless External Alarm will siren when the Tamper Switch is activated.

Please disarm the unit before you replace the battery or before you conduct any kind of service maintenance (i.e. checking or cleaning the unit)

SOLAR POWER INSTALLATION (ONLY APPLICABLE TO SA-001S)

The External Wireless Alarm SA-001S is equipped with a solar panel, this solar panel is installed on top of the cover to charge rechargeable batteries during the day. During darkness, a insignificant amount of energy is released from the rechargeable battery to operate the external wireless alarm.

The Wireless External Alarm should be installed to the outside of your house or building in a position to gather as much sunlight as possible. Avoid any shadows cast by walls, trees and roof overhangs to the Wireless External Alarm. Ideally to install the Wireless External Alarm facing due south optimize for solar exposure. However, install the unit facing east or west position will suffice.

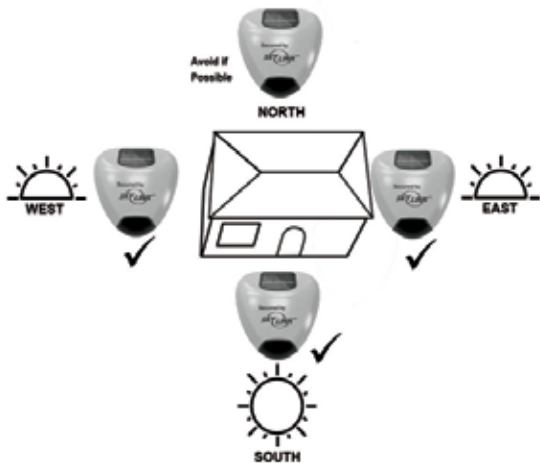

MAINTENANCE

Your Wireless External Alarm requires few simple maintenance to ensure its continued reliability and operation.

- The solar panel on the top housing should be cleaned using the soft and damp cloth. This will ensure the solar panel receives all the available light.
- Test the Wireless External Alarm periodically to ensure the unit is working.

TROUBLE SHOOTING

Questions	Solutions
Why the Wireless External Alarm does not respond to the sensors or remote?	You must program the sensors or remote to the Wireless External Alarm before they can work together.
Why I can't arm my system?	Make sure none of the sensors are triggered. For example, the door/window sensor should be in close status.
Why isn't the Wireless External Alarm beeping yet the lights are all flashing?	You have set the Alert Notification Jumper to 'Disable', this will disable the beeping. Reset this jumper to 'Enable' will enable the beeping.
How can I erase just one sensor or remote from the Wireless External Alarm?	You cannot erase just one sensor or remote from the unit. You must erase all sensors or remote and then program the ones that you want to keep.
Will the Wireless External Alarm function properly if no back up batteries are installed?	The Wireless External Alarm will function properly if there is AC power (model SA-001A), even without the backup batteries. The backup batteries provide power when there is no AC power, e.g. during power failure.

This device complies with Part 15 of the FCC Rules. Operation is subject to the following two conditions:

- (1) This device may not cause harmful interference, and
- (2) This device must accept any interference received, including interference that may cause undesired operation.

WARNING:

Changes or modifications to this unit not expressly approved by the party responsible for compliance could void the user's authority to operate the equipment.

NOTE:

This equipment has been tested and found to comply with the limits for a Class B digital device, pursuant to Part 15 of the FCC Rules. These limits are designed to provide reasonable protection against harmful interference in a residential installation. This equipment generates, uses and can radiate radio frequency energy and, if not installed and used in accordance with the instructions, may cause harmful interference to radio communications.

However, there is no guarantee that interference will not occur in a particular installation. If this equipment does cause harmful interference to radio or television reception, which can be determined by turning the equipment off and on, the user is encouraged to try to correct the interference by one or more of the following measures:

- Reorient or relocate the receiving antenna.
- Increase the separation between the equipment and receiver.
- Connect the equipment into an outlet on a circuit different from that to which the receiver is connected.
- Consult the dealer or an experienced radio/TV technician for help.

IC

Le présent appareil est conforme aux CNR d'Industrie Canada applicables aux appareils radio exempts de licence. L'exploitation est autorisée aux deux conditions suivantes : (1) l'appareil ne doit pas produire de brouillage, et (2) l'utilisateur de l'appareil doit accepter tout brouillage radioélectrique subi, même si le brouillage est susceptible d'en compromettre le fonctionnement.

CE

Declaration of Conformity

This equipment complies with the requirements relating to electromagnetic compatibility, EN 300220-2, EN301489-3, EN61058-1. This equipment conforms to the essential requirement of the Directive (1999/5/EC) of the European Parliament and of the Council.



WARRANTY

If, within one year from date of purchase, this product should become defective (except battery), due to faulty workmanship or materials, it will be repaired or replaced, without charge. *Proof of purchase and a Return Authorization Number are required.*

CUSTOMER SERVICE

If you would like to

- find out the up-to-date specifications
- know more about features and applications
- download documents, i.e. user's instructions
- order Skylink products

or if you have difficulty getting the products to work, please:

1. visit our FAQ section at www.skylinkhome.com, or
2. email us at support@skylinkhome.com

CUSTOMER SERVICE

Rm 1303, Block B, Veristrong Industrial Centre,
36 Aupuiwan Street, Fotan, N.T. Hong Kong.

Email: sales@skylinkhome.com

<http://www.skylinkhome.com>

©2012 SKYLINK GROUP

17 Shread Avenue,
Brampton, Ontario,

Canada L6Y 1J3

Email: sales@skylinkhome.com

<http://www.skylinkhome.com>

©2012 SKYLINK GROUP

