

Universal Garage Door Remote Control

Model GS1

1. INTRODUCTION

Congratulations on your purchase of GS1, the package includes Skylink® garage door receiver - Smart Button™ GB-318, and Skylink® garage door transmitter - remote control G6T3. In this package, you will find the following:

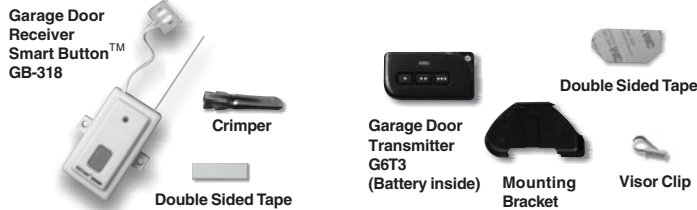

Connect the receiver - Smart Button™ GB-318 to your current garage door opener system, you can use the transmitter - remote G6T3 to open or close the garage door.

2. RECEIVER INSTALLATION



WARNING
Unplug the power cord of your garage door opener before installation to ensure power is not connected.
DO NOT let children use the garage door Transmitter without adult supervision. Children can injure themselves or others by the garage door.
DO NOT use remote to control the door without safety beams.

1. Open up the "Easy Clip™" and place it underneath the existing 2 wires of the wall button / wall console.
2. Ensure a pair of the wall button ribbon wires are placed properly inside the channels of the "Easy Clip™".

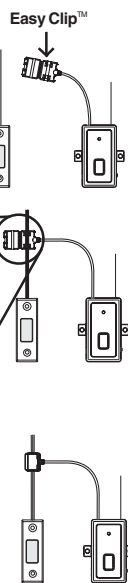

NOTE:
Ensure the ribbon wires are not twisted but laid flat inside the clip.

If your wall button ribbon wires are not the same kind as shown in the diagram, please refer below (4) or visit our website www.skylinkhome.com or contact us for more information.

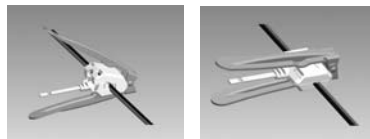

3. Press and lock the clip by snapping it together. The included Crimper helps you lock the "Easy Clip™". Close the cover and press down to lock the cover using this Crimper until you hear a "click".
4. If the "Easy Clip™" cannot clip with the wires from your wall button, cut off the "Easy Clip™" then connect two wires from the Smart Button™ GB-318 to the wall button.
 - a) Disconnect the existing wall button from the wall.
 - b) Connect the 2 wires from the Smart Button™ GB-318 to your existing wall button. Polarity does not matter, so simply pick one wire from the Smart Button™ GB-318 and connect it to one of the screw terminals on your wall button. Connect the 2nd wire to the other screw terminal.
 - c) Reconnect the wall button back.
5. If the wall button wires are hidden inside the wall, please connect the "Easy Clip™" to the exposed wires attached to the terminals of the garage door opener.

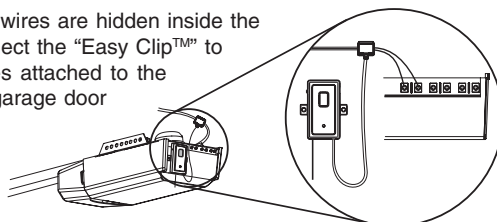

6. Power up the garage door opener, the red LED on the Smart Button™ GB-318 should keep flashing slowly within 2 minutes.

2. RECEIVER INSTALLATION (CONT)

If the Smart Button™ GB-318's red LED does not flash after the Smart Button™ GB-318 has been connected to the wall button's wires for 2 minutes, your garage door opener is probably too old. However, the Smart Button™ GB-318 will still work if you plug in an adapter (purchased separately). Please contact Skylink® to purchase the adapter.

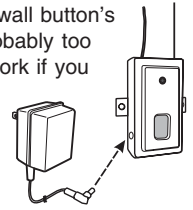

Rating of the transformer:
12V DC, 100mA \ominus \oplus
Diameter of DC plug : 3.5mm

7. Secure the SmartButton™ GB-318 properly with the mounting accessories.

Note: Do not cut the antenna! Straighten up the antenna to improve signal reception.

Note: After installation of the "Easy Clip™", if you want to re-install the Smart Button™ GB-318 to another place, please open the "Easy Clip™" by gently unlocking the two buckles with a screw driver, and remove it from the wires. Do not re-use the "Easy Clip™", refer to Step 4 to re-install it.

3. PROGRAM TRANSMITTER G6T3 TO RECEIVER GB-318

You need to do the programming in order to add the transmitter to a receiver.

Smart Button™ GB-318 can learn up to 10 remote controls.

To add remote controls, follow the instructions below:

1. Press the learn button on the side of the Smart Button™ GB-318.
2. Once the learn button is pressed, the LED will flash quickly. Release the learn button.
3. Within 30 seconds, press any one of the 3 buttons on the transmitter that you want to program to the receiver.
4. Once the remote control is programmed, the LED will flash slowly, in the same way as it flashes in standby mode.
5. You may now operate the garage door opener with this new remote control.
6. To program this transmitter to control another receiver, repeat process (1) to (4) to program another button on the remote control.

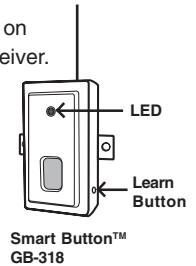

4. OPERATION

If the red LED flashes slowly, the Smart Button™ GB-318 is in standby mode. When a valid remote control signal is received, it will open / close the garage door.

Press the programmed button on the remote control or Smart Button™ GB-318, it will open / close the garage door.

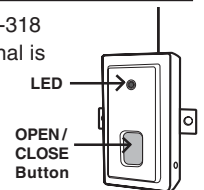

5. ERASE TRANSMITTERS

To erase unwanted remote control(s) from the memory of Smart Button™ GB-318, first erase all remote controls, then learn the one(s) you would like to keep, follow the steps below:

1. Press and hold the learn button for approximate 10 seconds.
2. The LED will flash rapidly after 10 seconds to indicate all the programmed remote controls have been erased. You may now release the learn button.
3. You have erased all the remote controls programmed to the Smart Button™ GB-318.

6. TROUBLE SHOOTING

Q: What can I do if the door opener does not react after I press the button on the transmitter ?

- A:**
- Ensure when the button on the transmitter is pressed, the red LED on the transmitter comes on. Otherwise, check if the battery is inserted properly.
 - Make sure the correct button on the transmitter is pressed.
 - Ensure the wires that were previously connected to the wall mounted door control are not loose.
 - Ensure the transmitter has been programmed to the receiver. Refer to section 2 for how to program a transmitter to the receiver.

7. TRANSMITTER MOUNTING METHOD

This three-button remote control G6T3 can be mounted on the windshield or visor of your car with mounting accessories. First use the double sided tape to attach the mounting bracket on the windshield or use the visor clip to clip the mounting bracket on the visor, then you can put the remote control on the bracket. The remote control can also be attached to your key ring as a key fob.

7. TRANSMITTER MOUNTING METHOD (CONT)

Mounted on the windshield

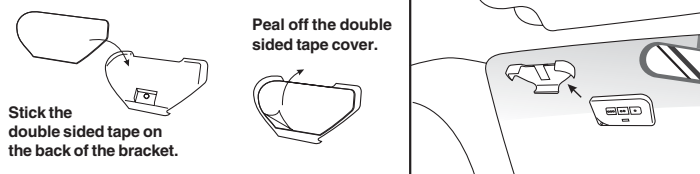

Mounted on the visor

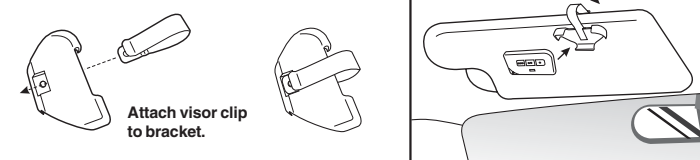

8. TRANSMITTER PASSWORD PROTECTION

Password protection

The G6T3 can be password protected. If you enable the password protection, you can only operate G6T3 after you input the correct password.

Password can be 2-8 digits long, which is a combination of 1, 2 and 3. For example, password can be 1, 2, 1, 2. To input this password, you have to press [●], then [●●], then [●], then [●●].

Note:

[●] = Button 1 [●●] = Button 2 [●●●] = Button 3

Note:

The time-out period is 1 second during above password input.

The factory default password is 2, 2, 2, which is disabled out of factory.

Change password

1. Press 1 and 3 simultaneously and hold for more than 6 seconds until the LED changes from flashing quickly to flashing slowly.
2. Input old password.
3. Press 1 and 3 simultaneously to confirm. If the password is wrong, the LED will flash 3 times and you have to start it over from step 1.
4. Input new password.
5. Press 1 and 3 simultaneously to confirm.
6. Input new password again.
7. Press 1 and 3 simultaneously to RE-confirm. If the password is different from the one of step 4, the LED will flash 3 times and you have to start over from step 1. Otherwise, the password has been changed to the new one and the password protection is enabled.

Disable password

1. Press 1 and 3 simultaneously and hold for more than 2 seconds until the LED flashes quickly but not until the LED flashes slowly.
2. Input old password.
3. Press 1 and 3 simultaneously to confirm. If the password is correct, the password protection will be disabled.

Enable password

1. Press 1 and 3 simultaneously and hold for more than 2 seconds until the LED flashes quickly but not until the LED flashes slowly.
2. Input old password.
3. Press 1 and 3 simultaneously to confirm. If the password is correct, the password protection will be enabled.

You can toggle the two states - password protection enabled or disabled.

Note:

The time-out period is 10 seconds during any of the above setting operations. After 10 seconds, the LED will flash 3 times and the remote will exit from setting.

If you forget your password and want to reset G6T3, follow the steps below:

1. Press 1 and 2 simultaneously and hold for more than 10 seconds until the LED flashes.
2. After you release 1 and 2, the LED will be turned off and G6T3 will be reset. The password will be reset to factory default.

After the reset, password protection is removed but the remote can not control any receiver until you reprogram it to receivers you want to control.

9. OPTIONAL ACCESSORIES AND OPERATIONS

You can add up to 10 additional transmitters to control the GB-318. Skylink® offers different lighting control / automation transmitters, Visor Transmitters, Keychain Transmitters and Keypad Transmitters to work with your receiver.



Program additional remote controls

Smart Button™ GB-318 can learn up to 10 remote controls.

To learn additional remote controls, follow the instructions below:

1. Press the learn button on the side of the GB-318.
2. Once the learn button is pressed, the LED will flash quickly. Release the learn button.
3. Within 30 seconds, press the button on the remote control you would like to program.
4. Once the remote control is programmed, the LED will flash slowly, in the same way as it flashes in standby mode.
5. You may now operate the garage door opener with this remote control.

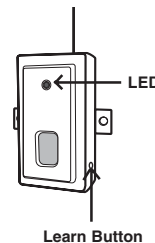

For more information, please visit our website at www.skylinkhome.com or contact us.

10. BATTERY

3 Volt lithium battery (CR 302) (included).

It is time to change the battery when the red LED on the transmitter does not turn on when either button is pressed.

11. WARNING

DO NOT let children use the garage door transmitter without adult supervision. Otherwise, Children and others may be injured by the garage door.

12. FCC

This device complies with Part 15 of the FCC Rules. Operation is subject to the following two conditions: (1) This device may not cause harmful interference, and (2) This device must accept any interference received, including interference that may cause undesired operation.

WARNING:

Changes or modifications to this unit not expressly approved by the party responsible for compliance could void the user's authority to operate the equipment.

NOTE:

This equipment has been tested and found to comply with the limits for a Class B digital device, pursuant to Part 15 of the FCC Rules. These limits are designed to provide reasonable protection against harmful interference in a residential installation. This equipment generates, uses and can radiate radio frequency energy and, if not installed and used in accordance with the instructions, may cause harmful interference to radio communications.

However, there is no guarantee that interference will not occur in a particular installation. If this equipment does cause harmful interference to radio or television reception, which can be determined by turning the equipment off and on, the user is encouraged to try to correct the interference by one or more of the following measures:

- Reorient or relocate the receiving antenna.
- Increase the separation between the equipment and receiver.
- Connect the equipment into an outlet on a circuit different from that to which the receiver is connected.
- Consult the dealer or an experienced radio/TV technician for help.

13. WARRANTY

If, within one year from date of purchase, this product should become defective (except battery), due to faulty workmanship or materials, it will be repaired or replaced, without charge. Proof of purchase and a Return Authorization are required.

14. CUSTOMER SERVICE

If you would like to

- find out the up-to-date specifications
- know more about features and applications
- download documents, i.e. user's instructions
- order Skylink products

or if you have difficulty getting products to work, please:

1. visit our FAQ section at www.skylinkhome.com, or
 2. email us at support@skylinkhome.com, or
 3. call our toll free at 1-800-304-1187 from Monday to Friday, 9 am to 5 pm EST.
- Fax (800) 286-1320

CUSTOMER SERVICE

17 Sheard Avenue, Brampton, Ontario, Canada L6Y 1J3

Email: support@skylinkhome.com

<http://www.skylinkhome.com>

P/N. 101Z865-002

Patent Pending

® are registered trademarks of their respective corporations

©2010 SKYLINK GROUP