

12-Inch Mirror Camera

EV-6600-N2BQ

The **ENFORCER** Mirror Camera is the perfect solution for discreetly monitoring cash register users, corners, aisles, hallways, warehouses, and more.

Features:

- Camera is mounted behind a mirror for discreet monitoring.
- 1/3" Sony Super HAD II CCD.
- 600 TV Lines.
- 2.8mm Lens.
- 3-Axis mounting arm allows for flexible installations.
- Low current draw: 67mA@12VDC.
- OSD (On-Screen Display) for convenient programming of special features such as brightness, digital wide dynamic range (DWDR), white balance, backlight compensation (BLC), motion detection, privacy, and more.

Specifications:

Model	EV-6600-N2BQ
Type	12" Mirror Camera
CCD	1/3" Sony Super HAD II CCD
Resolution	600 TV lines
Size (Diameter)	12" (305mm)
Lens	2.8mm
Pickup elements	768 x 494 pixels
Video output format	NTSC
Sync	Internal
Video output	1Vp-p composite video, 75Ω
Minimum illumination	0.1 Lux
S/N Ratio	>48dB
Shutter control	Max 1/100,000 sec.
Gain control	Auto
White balance	Auto
Backlight compensation	Built-in
Operating voltage	12VDC
Current draw	67mA
Operating temperature	14°~122° F (-10° ~50° C)
Weight	32-oz (907g)



3-Axis Mounting Arm:

The mounting arm moves in 3 directions, allowing the camera to mount at an angle suitable for your installation.

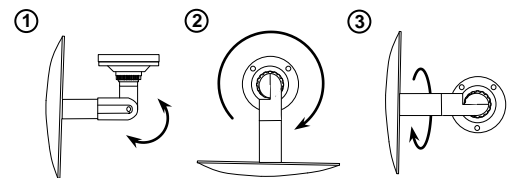

Also Available from SECO-LARM:



PIR Camera



Covert Ceiling Mount Camera



Wall-Plate Camera



UFO Camera

SECO-LARM®

16842 Millikan Ave • Irvine, CA 92606

Tel: 949-261-2999 / 800-662-0800 • Fax: 949-261-7326

sales@seco-larm.com • www.seco-larm.com



Copyright 2012 © SECO-LARM U.S.A., Inc. All rights reserved.

The SECO-LARM policy is one of continual development. For that reason, SECO-LARM reserves the right to change prices and specifications without notice. SECO-LARM is not responsible for misprints.

ENFORCER® SECO-LARM® CRIMEBUSTER® CBA SLI

PI-EV-6600-x2BQ.docx