

## QuickPort® Female to Female S-Video Adapter

### APPLICATION

Video connectivity for workstation cabling with shielded video cable. QuickPort Connectors snap into any housing with the QuickPort name—flush and surface mount outlets, Multimedia Outlet System (with adapter), Decora® Inserts, patch panels, and patch blocks.

### FEATURES

- Compatible with all QuickPort wallplates and housings
- Mates with 4-Contact Mini-DIN plugs

### PHYSICAL SPECIFICATIONS

Dimensions: .63"H x .83"W x 1.38"D

### DESIGN CONSIDERATIONS

- QuickPort Connectors snap into any housing with the QuickPort name: flush and surface mount outlets, Multimedia Outlet System (with adapter), patch panel, and patch blocks
- Check clearance behind proposed location of bulkhead module to ensure space for proper bend-radius of cabling media
- Not for side-by-side use with 49910-xx4 modular face plates (insufficient space between ports)
- Connectors are available in ivory and white to match housings or wallplates

### WARRANTY INFORMATION

For a copy of Leviton product warranties, visit [www.leviton.com](http://www.leviton.com).

### TYPICAL SPECIFICATION

The connectors for video connectivity shall be individual snap-in style female-to-female adapters, and shall fit all other QuickPort installed telecommunications wallplates, outlets, and field-configurable patch panels and patch blocks. Connectors shall be available in ivory and white to match the housings or wallplates.



### DIMENSIONAL LINE ART

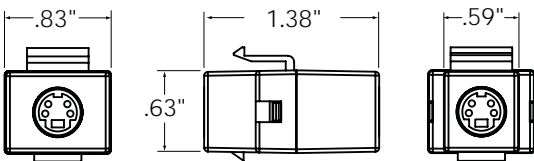

### PART NUMBERS

Description	Part No.
QuickPort Female to Female, S-Video, Ivory	40734-CVI
QuickPort Female to Female, S-Video, White	40734-CVW

QuickPort Female to Female S-Video Adapter